

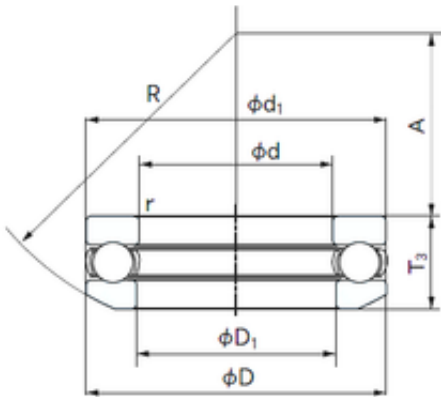

LEDONG Machinery Co., Ltd.

NACHI 53410 thrust ball bearings

Bearing No. 53410



53410 Bearing 2D drawings and 3D CAD models

Size	50x110x45.6 mm
Bore Diameter	50 mm
Outer Diameter	110 mm
Width	45.6 mm
d	50 mm
D	110 mm
T	45.6 mm
d1	110 mm
r min.	1.5 mm
A	35 mm
D1	52 mm
R	90 mm
Weight	1.97 Kg
Basic dynamic load rating (C)	148 kN
Basic static load rating (C0)	283 kN
(Grease) Lubrication Speed	1400 r/min