

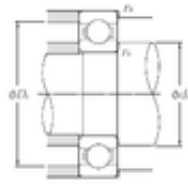

LEDONG Machinery Co., Ltd.

110 mm x 150 mm x 20 mm NTN 6922LLU deep groove ball bearings

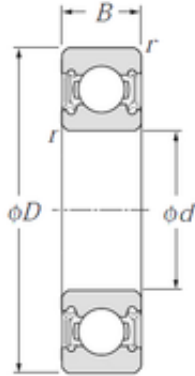

Bearing No. 6922LLU

6922LLU Bearing 2D drawings and 3D CAD models

Size	110x150x20 mm
Bore Diameter	110 mm
Outer Diameter	150 mm
Width	20 mm
d	110 mm
D	150 mm
B	20 mm
C	20 mm
r min.	1,1 mm
da min.	116,5 mm
da max	120 mm
Da max.	143,5 mm
ra max.	1 mm
Weight	0,849 Kg
Basic dynamic load rating (C)	43,5 kN
Basic static load rating (C0)	44,5 kN
Reference speed	2 400 r/min
Category	Single Row Ball Bearings
Inventory	0.0
Manufacturer Name	NTN
Minimum Buy Quantity	N/A
Weight / Kilogram	0
EAN	4547359588095
Product Group	B00308
Enclosure	2 Seals



LEDONG Machinery Co., Ltd.

Precision Class	ABEC 1 ISO P0
Maximum Capacity / Filling Slot	No
Rolling Element	Ball Bearing
Snap Ring	No
Internal Special Features	No
Cage Material	Steel
Enclosure Type	Contact Seal
Internal Clearance	C0-Medium
Inch - Metric	Metric
Long Description	110MM Bore; 150MM Outside Diameter; 20MM Outer Race Width; 2 Seals; Ball Bearing; ABEC 1 ISO P0; No Filling Slot; No Snap Ring; No Internal Special Features; C0-Medium Internal Clearance; Steel Cage
Other Features	Deep Groove Double Lip Friction Nitrile Rubber Seal -20 To 120 Deg C Shell Alvania Prelubricated
Category	Single Row Ball Bearing
UNSPSC	31171504
Harmonized Tariff Code	8482.10.50.68
Noun	Bearing
Keyword String	Ball
Manufacturer URL	http://www.ntnamerica.com
Weight / LBS	1.87
Outer Race Width	0.787 Inch 20 Millimeter
Bore	4.331 Inch 110 Millimeter
Outside Diameter	5.906 Inch 150 Millimeter
Inner Race Width	0 Inch 0 Millimeter