

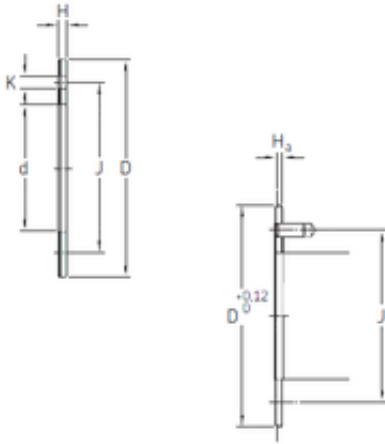

# LEDONG Machinery Co., Ltd.



## SKF PCMW 142601.5 M plain bearings

Bearing No. PCMW 142601.5 M

PCMW 142601.5 M Bearing 2D drawings and 3D CAD models

Size	14x26x1.5 mm
Bore Diameter	14 mm
Outer Diameter	26 mm
Width	1,5 mm
d	14 mm
D	26 mm
H	1,5 mm
J	20 mm
K	2,25 mm
Ha min.	1 mm
Weight	0,0036 Kg
Basic dynamic load rating (C)	45 kN
Category	Bearings
Inventory	0.0
Manufacturer Name	SKF
Minimum Buy Quantity	N/A
UNSPSC	31171515
Weight / Kilogram	0.003
Product Group	B04264
D <sub>a</sub>	26 mm
J <sub>a</sub>	20 mm
H <sub>a</sub>	1 mm
Basic dynamic load rating - radial direction C	45 kN
Basic static load rating - radial direction C <sub>0</sub>	93 kN



## LEDONG Machinery Co., Ltd.

Specific dynamic load factor $K$	120 N/mm <sup>2</sup>
Specific static load factor $K_0$	250 N/mm <sup>2</sup>
Factor depending on material and bearing type $K_M$	1900
Permissible sliding velocity $v$ max.	2.5 m/s
Permissible sliding velocity $v$ min.	0 m/s
Coefficient of friction $\mu$ max.	0.2
Coefficient of friction $\mu$ min.	0.02
Mass thrust washer	0.0036 kg