

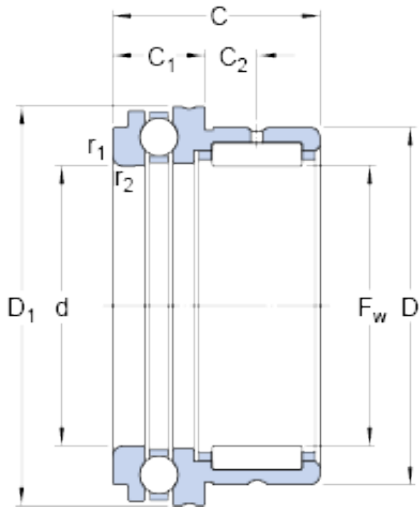

LEDONG Machinery Co., Ltd.



NKX 60 Bearing 2D drawings and 3D CAD models

SKF NKX 60 cylindrical roller bearings

Bearing No. NKX 60

Size	72x60x40 mm
Bore Diameter	72 mm
Outer Diameter	60 mm
Width	40 mm
F_w	60 mm
D	72 mm
C	40 mm
C_1	17 mm
C_2	12 mm
d	60 mm
D_1	85.2 mm
$r_{1,2}$ - min.	1 mm
d_a - min.	80.5 mm
r_a - max.	1 mm
r_b - max.	1 mm
d_i	50 mm
F	60 mm
B_i	25 mm
Basic dynamic load rating, radial direction - C	41.8 kN
Basic static load rating, radial direction - C_0	96.5 kN
Basic dynamic load rating, axial direction - C	41.6 kN
Basic static load rating, axial direction - C_0	122 kN



LEDONG Machinery Co., Ltd.

Fatigue load limit, radial direction - P _u	11.8 kN
Fatigue load limit, axial direction - P _u	4.6 kN
Reference speed	3600 r/min
Limiting speed	5000 r/min
Mass bearing	0.36 kg
Category	Roller Bearings
Inventory	0.0
Manufacturer Name	SKF
Minimum Buy Quantity	N/A
Weight / Kilogram	0.465
EAN	7316577014788
Product Group	B04144
bore diameter:	60 mm
dynamic load capacity:	41.8 kN
outside diameter:	85 mm
static load capacity:	96.5 kN
overall width:	40 mm
maximum rpm:	5000 rpm
needle bearing type:	Machined Bearing with No Inner Ring
flanges:	No Flange
closure type:	Open
series:	NKX
number of rows:	One
lubrication hole type:	Hole on Outer Ring
bearing material:	Steel
precision rating:	Not Rated
operating temperature range:	Maximum of +250 ° F ° F
manufacturer upc number:	7316577014788
cage material:	Steel



LEDONG Machinery Co., Ltd.

F_w	60 mm
C_1	17 mm
C_2	12 mm
D_1	85.2 mm
$r_{1,2}$ min.	1 mm
d_a min.	80.5 mm
r_a max.	1 mm
r_b max.	1 mm
d_i	50 mm
B_i	25 mm
Basic dynamic load rating, radial direction C	41.8 kN
Basic static load rating, radial direction C_0	96.5 kN
Basic dynamic load rating, axial direction C	41.6 kN
Basic static load rating, axial direction C_0	122 kN
Fatigue load limit, radial direction P_u	11.8 kN
Fatigue load limit, axial direction P_u	4.55 kN
Minimum axial load factor A	0.077
Inner ring	IR 50x60x25